

Specifications of FELCOM 250/FELCOM 500

Model	FELCOM 250	FELCOM 500
General		
Transmitting Frequency	1626.5 - 1660.5 MHz	
Receiving Frequency	1525.0 - 1559.0 MHz	
Interface		
Ethernet	RJ45	4 ports
2-wire analog telephone	RJ11 Phoenix 4 pin	2 ports
NMEA in/out	Phoenix 5 pin (NMEA0183 ver. 2)	1 port
Alarm output	Phoenix 3 pin Contact (Normal Close)	1 port
USIM/SIM	Plug in type	1 port
RS-232	9 pin D-Sub female connector (EIA574)	1 port
L-band output	BNC	1 port
Communication Services		
Voice	4 kbps circuit switched (AMBE+2 codec) ISDN 3.1 kHz Audio (Transparent)	
Data	ISDN UDI/RDI	N/A
	Standard IP (Best Effort Delivery)	284 kbps (RX), 225 kbps (TX) 432 kbps (RX), 372 kbps (TX)
	Streaming IP (Guaranteed Service Rate)	32, 64, 128 kbps 32, 64, 128, 256 kbps
SMS (Short Message Service)	Up to 160 characters	

Environment

Temperature	Antenna Unit (operative temperature)	-25°C - +55°C
	(storage temperature)	+70°C
	Below Deck Unit (operative temperature)	-25°C - +55°C
Waterproofing	Antenna Unit	IP56
Ship's motion	Roll	± 30°/8 sec
	Pitch	± 10°/6 sec
	Yaw	± 8°/50 sec
	Rate of Turn	± 6°/1 sec
	Ship's Speed	30 knot

Power Supply

Power Supply	10.8 - 31.2 VDC
FUSE	12 A (TX) at 12 VDC, 6 A (TX) at 24 VDC

EQUIPMENT LIST

Model	FELCOM 250	FELCOM 500
Standard		
Above Deck Unit		
Antenna Unit	FB-1250	FB-1500
Below Deck Unit		
Communication Unit		FB-2000
IP Handset		FB-8000
Option		
Incoming Indicator		FB-3000
Analog Telephone		FC755D1
G3 FAX		FAX-2810/2820
AC/DC Power Supply Unit		PR-240

FELCOM 250/500

Communication Unit

FB-2000

4.1 kg 9 lb

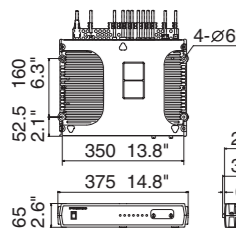

IP Handset

FB-8000

0.38 kg 0.8 lb

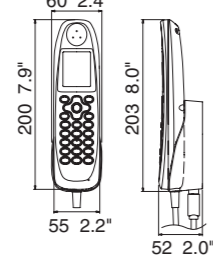

Incoming Indicator

FB-3000

Weight: TBD

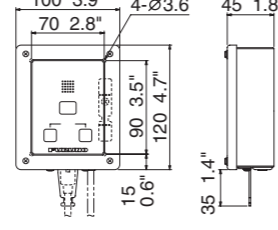

FELCOM 250

Antenna

FB-1250 (tentative)

10 kg 22 lb

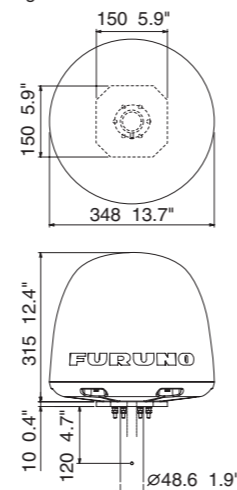

FELCOM 500

Antenna

FB-1500

18 kg 39.7 lb

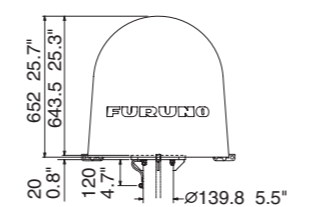
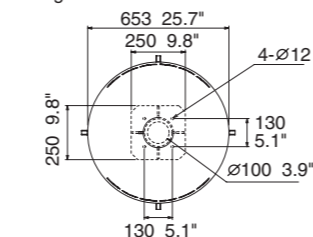

Antenna

FB-1500 (with an attachment)

21 kg 46.3 lb

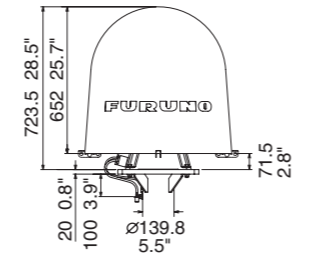
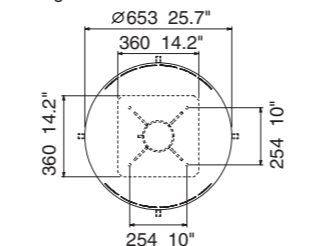

FURUNODEEPSEA.com

All brand and product names are registered trademarks, trademarks or service marks of their respective holders. SPECIFICATIONS SUBJECT TO CHANGE WITHOUT NOTICE

FURUNO ELECTRIC CO., LTD.

Nishinomiya, Hyogo, Japan
www.furuno.co.jp

FURUNO U.S.A., INC.

Camas, Washington, U.S.A.
www.furunousa.com

FURUNO (UK) LIMITED

Havant, Hampshire, U.K.
www.furuno.co.uk

FURUNO FRANCE S.A.S.

Bordeaux-Mérignac, France
www.furuno.fr

FURUNO ESPAÑA S.A.

Madrid, Spain
www.furuno.es

FURUNO DANMARK AS

Hvidovre, Denmark
www.furuno.dk

FURUNO NORGE A/S

Alesund, Norway
www.furuno.no

FURUNO SVERIGE AB

Västra Frölunda, Sweden
www.furuno.se

FURUNO FINLAND OY

Espoo, Finland
www.furuno.fi

FURUNO POLSKA Sp. z o.o.

Gdynia, Poland
www.furuno.pl

FURUNO DEUTSCHLAND GmbH

Rellingen, Germany
www.furuno.de

FURUNO EURUS LLC

St. Petersburg, Russian Federation
www.furuno.com.ru

FURUNO HELLAS LTD.

Piraeus, Greece



09051U Printed in Japan
Catalogue No. W-3254a

FleetBroadband



Features of FELCOM 250/FELCOM 500

- ▶ A wide variety of maritime broadband communication services available
- ▶ Simultaneous access to voice and high-speed data communications
- ▶ Global coverage provided through three Inmarsat-4 satellites (except for polar regions)
- ▶ IP handset and IP-PBX incorporated
- ▶ Multiple IP handsets can be incorporated into the network by using the Ethernet hub
- ▶ Wireless IP phones can be utilized (wireless LAN access points required)
- ▶ Integrated Web server
- ▶ Simplified installation through a compact antenna unit with a diameter of around 60 cm, weighing around 20 kg (FELCOM 500)
- ▶ Communication Unit supporting all major communication systems carrying ports to facilitate plug-and-play system integration
- ▶ Built-in NAT router facilitates smooth network integration to the Internet
- ▶ Incoming indicators available (optional supply)

FB-2000 Communication Unit

▼ Back

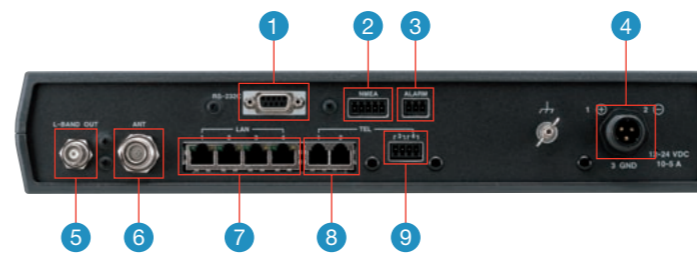

- 1 RS-232C 9pin D-Sub female connector for PC/Router
- 2 NMEA in/out Phoenix 5pin (NMEA 0183 Ver.2) for navigation equipment
- 3 Alarm output Phoenix 3pin for alarm equipment
- 4 For power supply
- 5 L-Band output BNC for ChartCo and others

▼ Front



- 6 For Antenna Unit (Antenna cable length selectable 30m or 50m)
- 7 LAN RJ45 ports for IP handsets, PC/network equipment, telephone hub
- 8 Telephone RJ11 for telephones and facsimile
- 9 Telephone Phoenix 4pin for telephones and facsimile
- 10 USIM/SIM card slot

FleetBroadband brings ship-to-shore operational and social communications to the broadband IP era

FURUNO's Inmarsat FleetBroadband, FELCOM 250 and FELCOM 500 deliver faster, more cost-effective solution to maritime broadband data and voice communications on a global basis. Once installed, FleetBroadband will turn a ship into a broadband floating office where constant, simultaneous access to voice and multiple high-speed data services are available, transforming access to data at sea. Increasing levels of both operational and social communications can be conducted all at the same time through this new service. Navigators can obtain weather and chart updates* online in order to optimize their route planning and monitoring tasks, while all onboard can enjoy the benefit of the Internet, e-mail and VoIP calls to the head offices or their friends and family back home all via a single terminal.

FleetBroadband represents a quantum leap in terms of marine communication speeds. With its data capability of up to 432 kbps (FELCOM 500) – more than three times the maximum for Fleet 77 service – it will alter the way mariners and vessels communicate, just as on-shore broadband data communications paved the way for the broadband IP era.

* available in the future

Comparison between Inmarsat FleetBroadband and Fleet Services

	FELCOM 250	FELCOM 500	FELCOM 70
Data Communication			
Standard IP (Best effort delivery)	Up to 284 kbps	Up to 432 kbps	MPDS up to 64 kbps
Streaming IP (Guaranteed data rate)	32, 64, 128 kbps	32, 64, 128, 256 kbps	N/A
ISDN	N/A	64 kbps	64 kbps
Voice	4 kbps AMBE+2/3.1 kHz audio Simultaneously usable with packet data and IP services		4.8 kbps AMBE/3.1 kHz audio NOT simultaneously usable with data service
FAX	Group 3 FAX via 3.1 kHz audio		9.6 kbps (Group 3), 64 kbps (Group 4)
SMS	Standard 3G (up to 160 characters)		N/A

FleetBroadband coverage

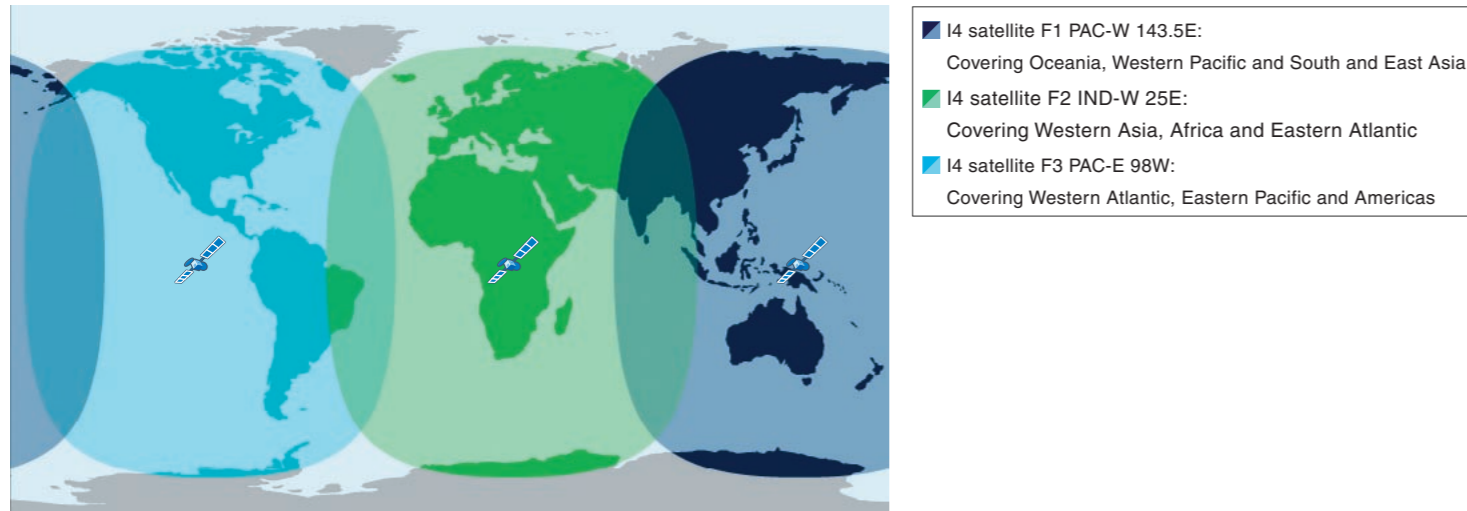

System Overview of FleetBroadband

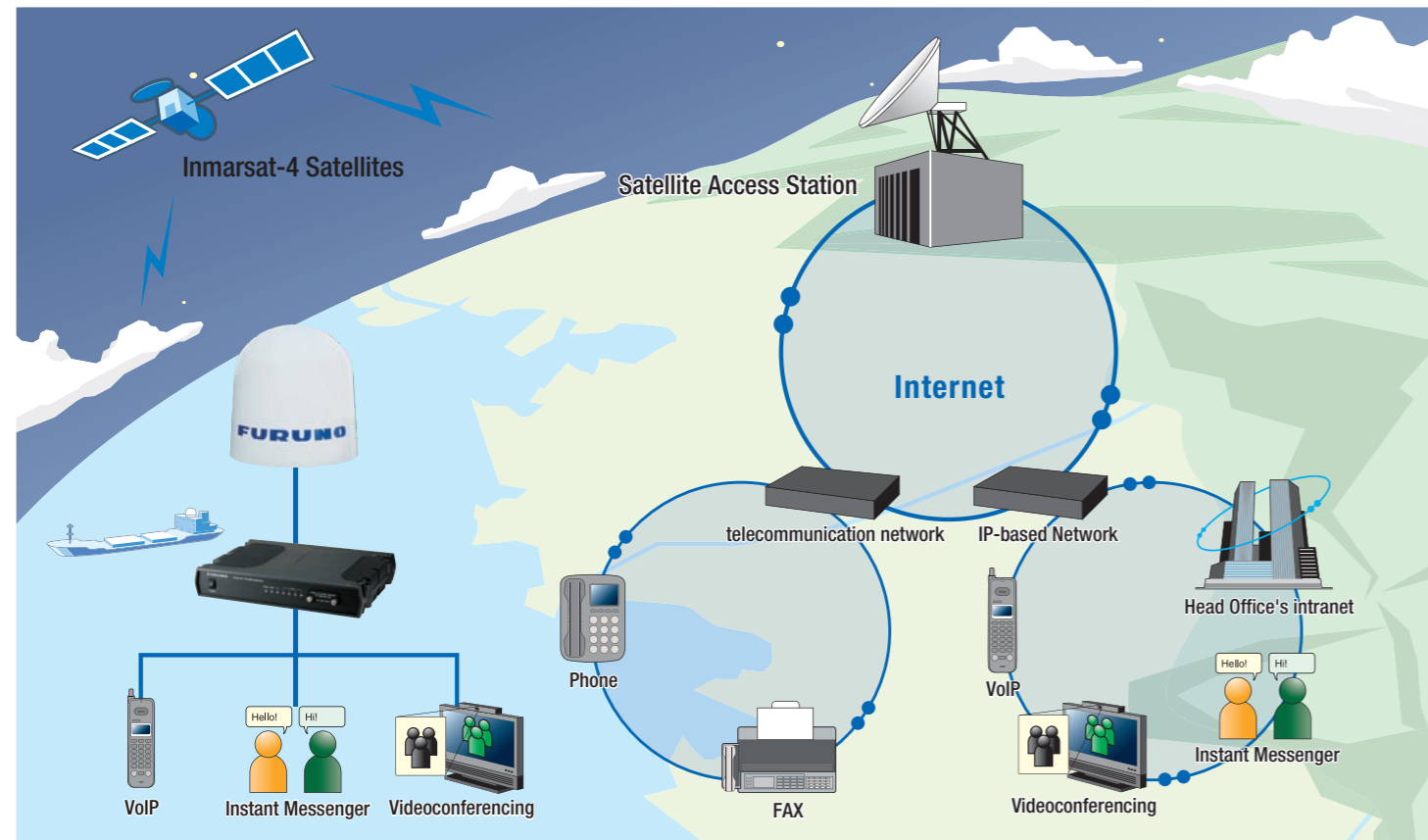

Features of Inmarsat FleetBroadband service applications

Selectable data rates for data communications according to needs:

Standard IP:

- Service providing best effort delivery of 432 kbps (FELCOM 500, 284 kbps for FELCOM 250) (connected through shared connection pipe: less traffic—higher throughput, and more traffic—lower throughput)
- Data service charged for data sent and received
- Suitable for typical office applications such as e-mail, web browsing, FTP, VPN, etc.

Streaming IP:

- Guaranteed streaming data rates on demand, rates selectable from 32, 64, 128 or 256 kbps (no contention amongst those who are connected in the same network—guaranteed throughput at all times)
- Suitable for bandwidth-hungry large data transfer, i.e., real-time streaming video and audio, Voice over IP, etc.
- Service charged for the duration of the connection to the network
- These dedicated streaming channels can run independently while the standard IP service is running in the background, meaning that a host of applications can be running simultaneously

Crystal clear voice telephony

- 4 kbps cost-effective, landline quality speech available
- Supports one circuit switched service at any one time
- Simultaneous use together with data communications

High stability in communication links achieves constant network availability even under harsh environmental conditions

Supports additional core voice and ISDN data capabilities for integration with legacy applications

- ISDN compatibility available on FELCOM 500

SMS (up to 160 characters) and voice mail

FleetBroadband System Configuration

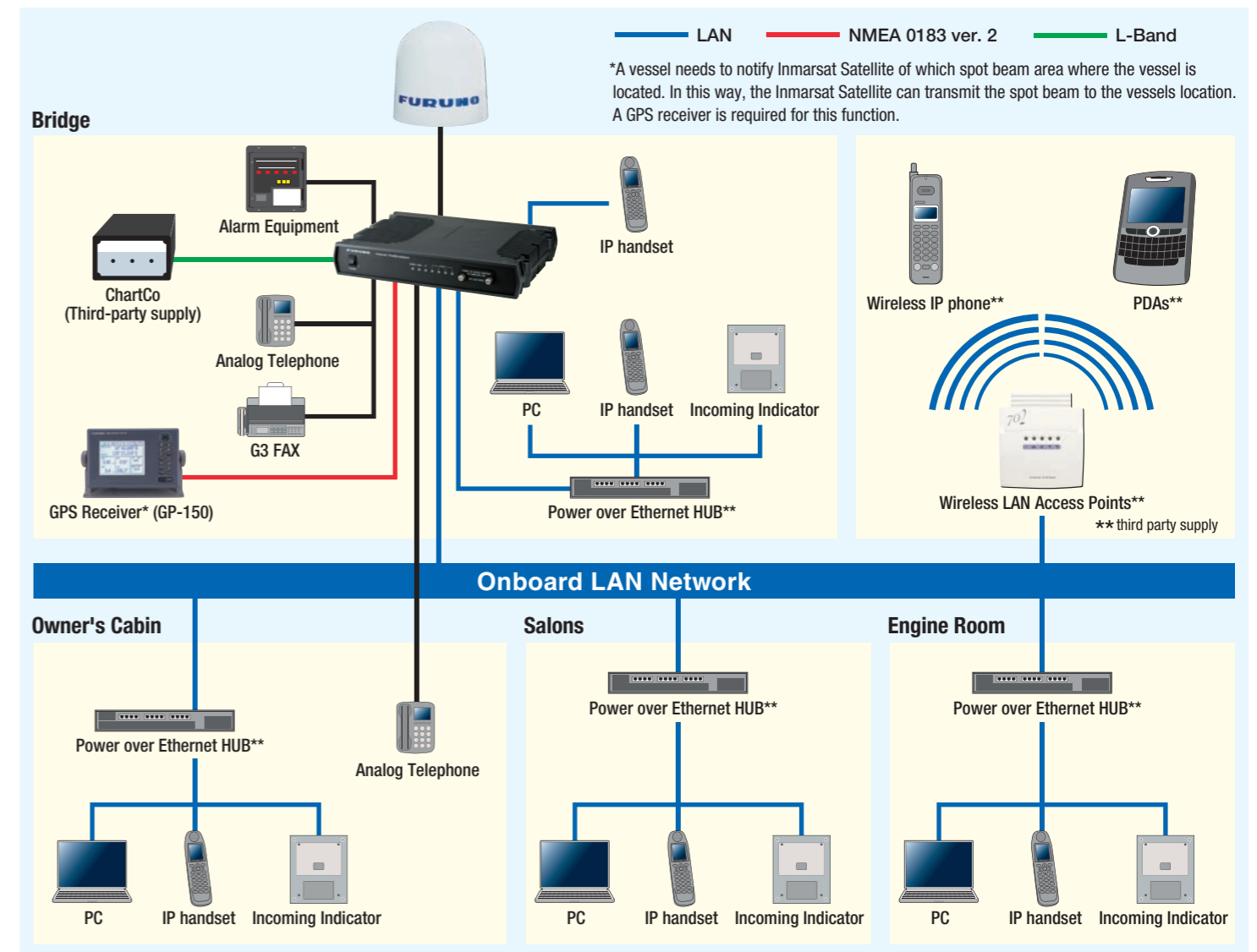

User applications of FleetBroadband

With its simultaneous voice and data capability, FELCOM 250 and FELCOM 500 can support an extensive range of user applications. All tasks can be conducted all at the same time through a single terminal.



Social communication and increased welfare for crewmembers

Crewmembers are now able to send SMS or make private phone calls to their friends and families back home. They can also browse the web to read news from home, football results or any other news of their interests.



Educational possibility for crewmembers using distance learning

Using their off-duty time in a more productive manner has become very popular amongst navigators. FleetBroadband allows crewmembers to attend off-campus distance learning courses through IP applications to further enhance their skills and academic levels while off-duty.



Troubleshooting in case of equipment failure

In case of failure of engine or other onboard equipment, chief engineers onboard can set up live, on-the-spot remote condition-review and troubleshooting sessions with service engineers from various manufacturers onshore by using two-way live video streaming. A reliable high bandwidth connection is essential for enabling these functions, and FleetBroadband provides a perfect solution.

Real-time chart and weather information update for route optimization*

Navigators can now update chart as well as weather information in real-time by which the optimal, fuel-efficient routes can be plotted from port to port based upon the up-to-the-minute chart and weather information.

* available in the future



Briefing with the head office, port authorities and others

Chief officers can conduct briefing with their head offices, port authorities and ship chandlers by using 4 kbps voice service, VoIP (Voice over Internet Protocol) and web mail for various occasions. Alternatively, they can make use of two-way live video streaming to facilitate videoconferencing if needed.



"Always on" connectivity to the internet and the head office's network through secure VPN connection

Crewmembers can access to the company's intranet through secure VPN connection.

